

GRATE AND FRAME DETAILS

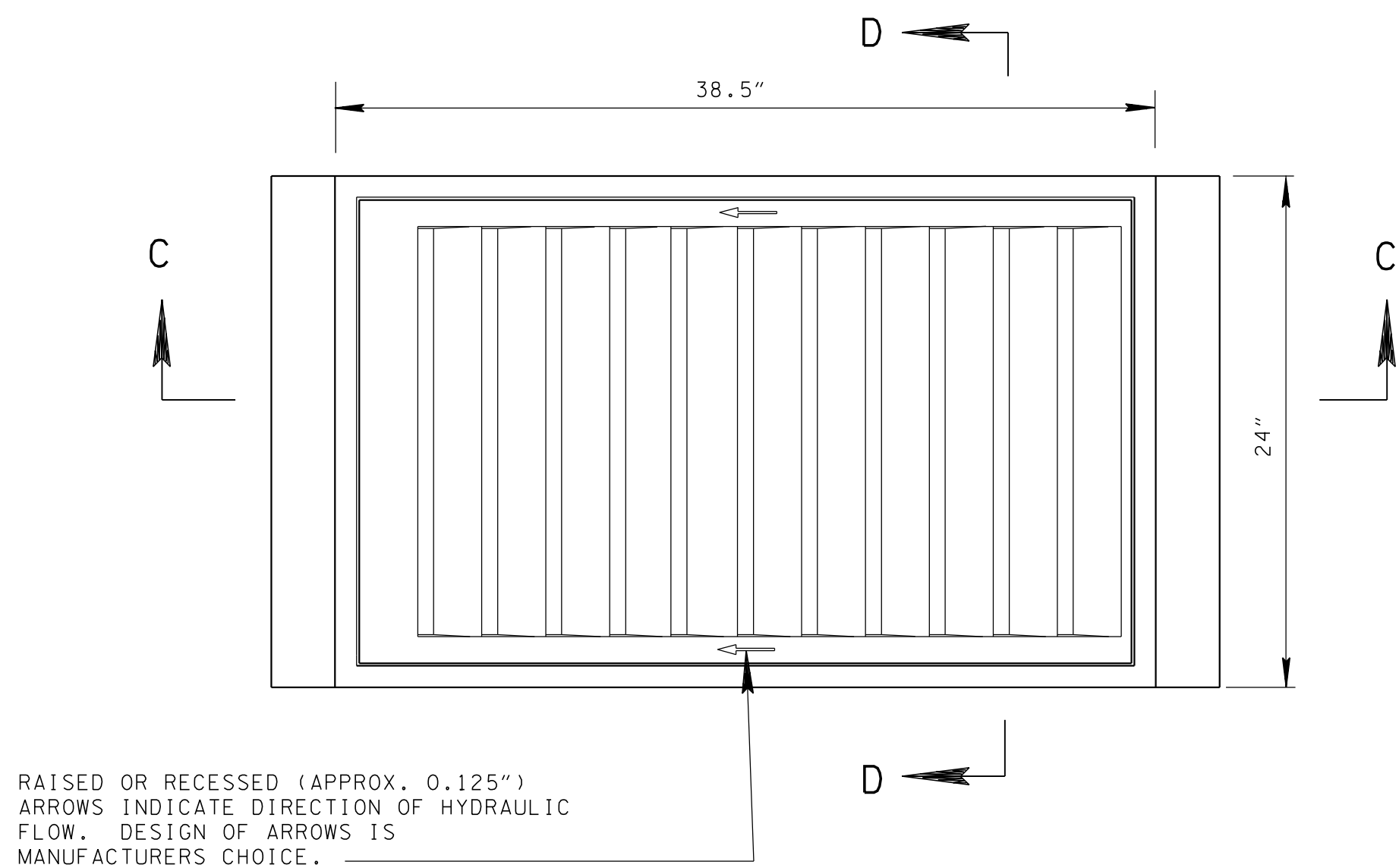

PLAN VIEW

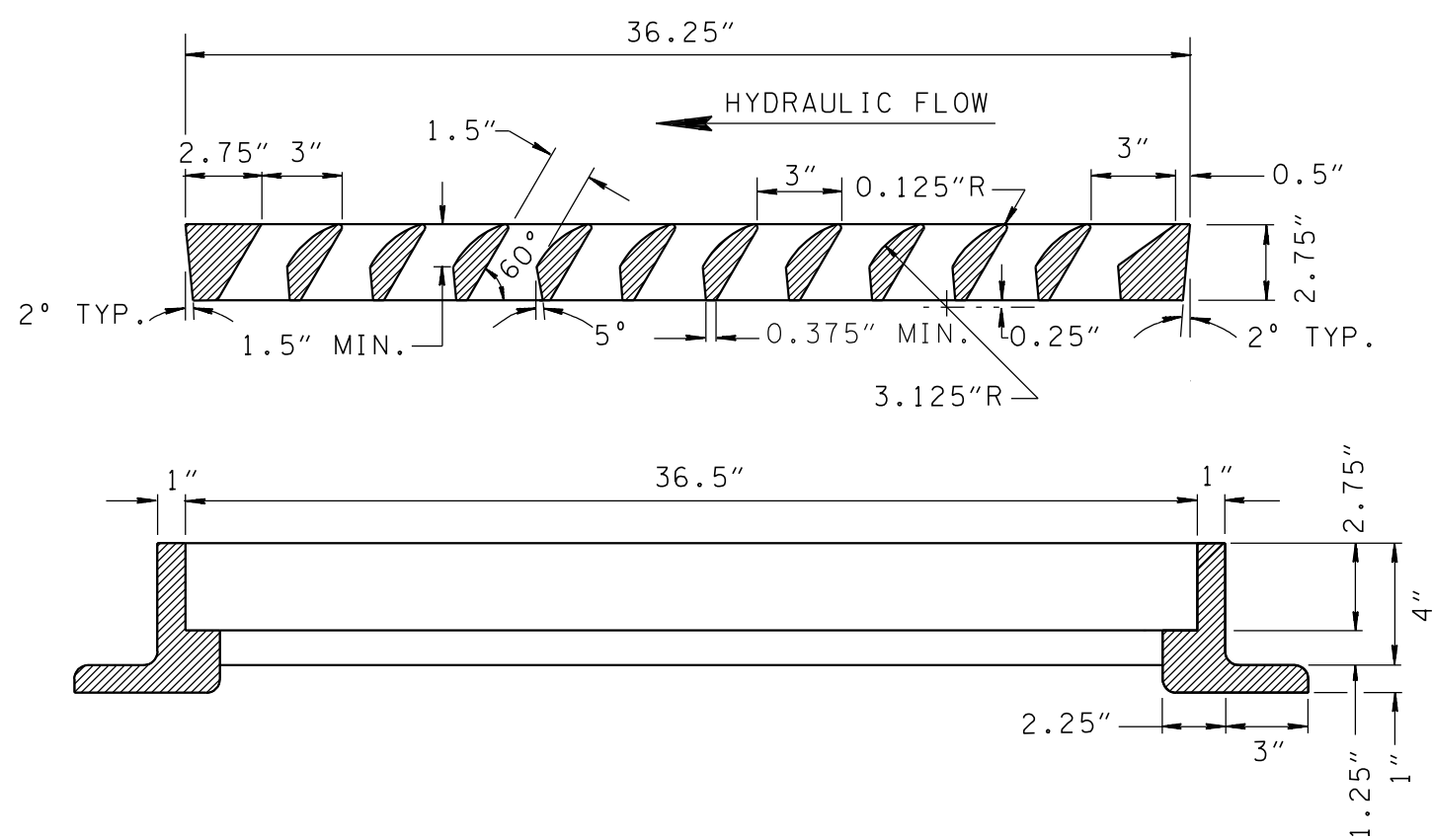

SECTION C-C

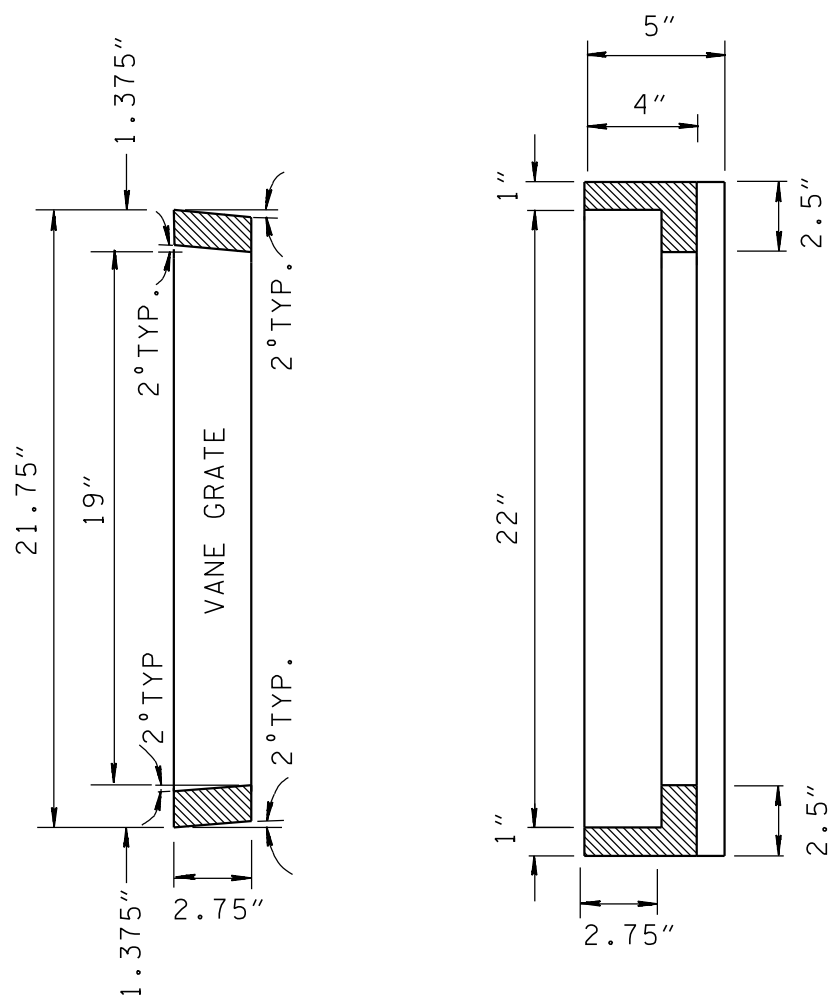

SECTION D-D

CURB INLET CASTING

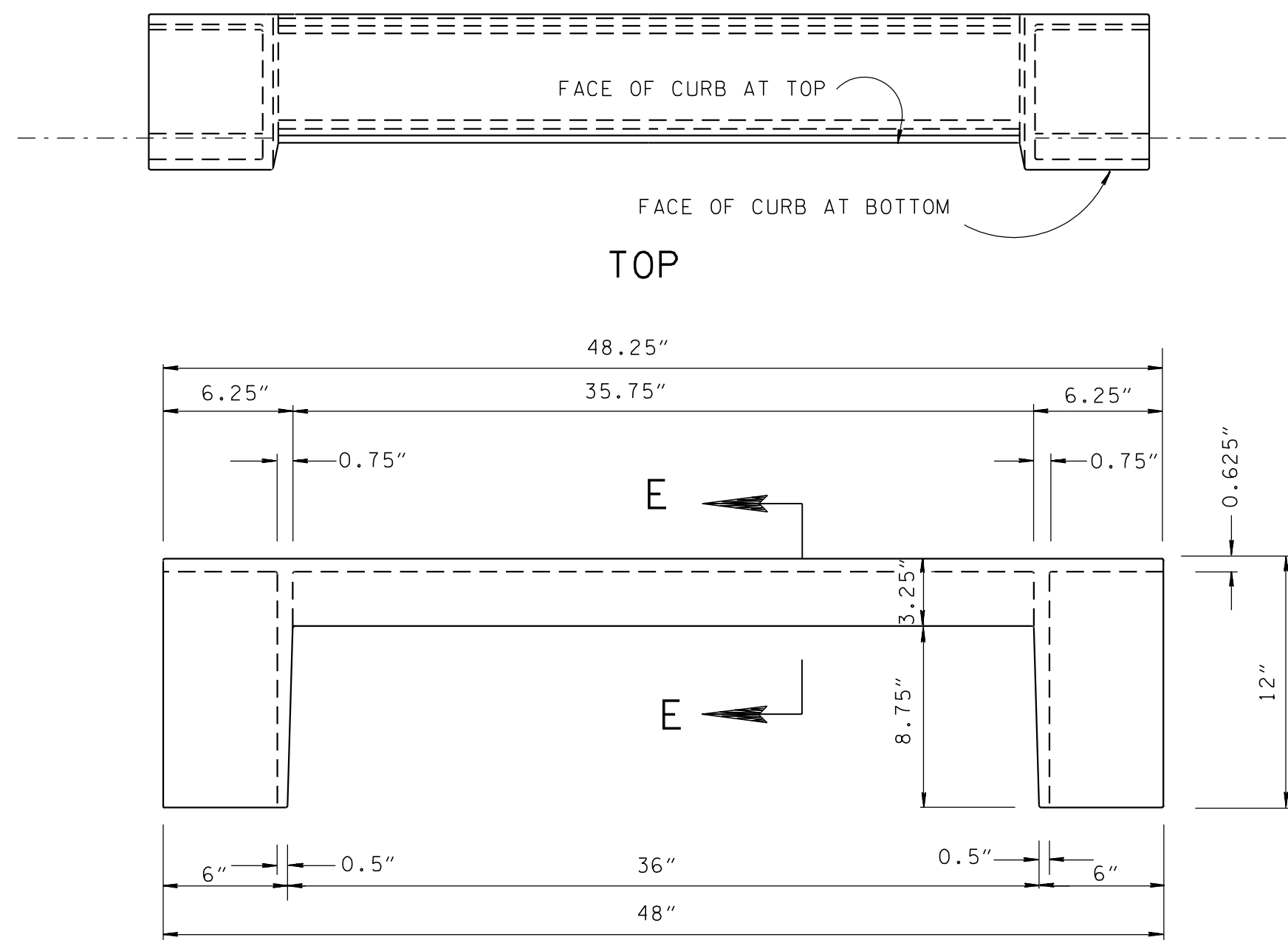

FRONT

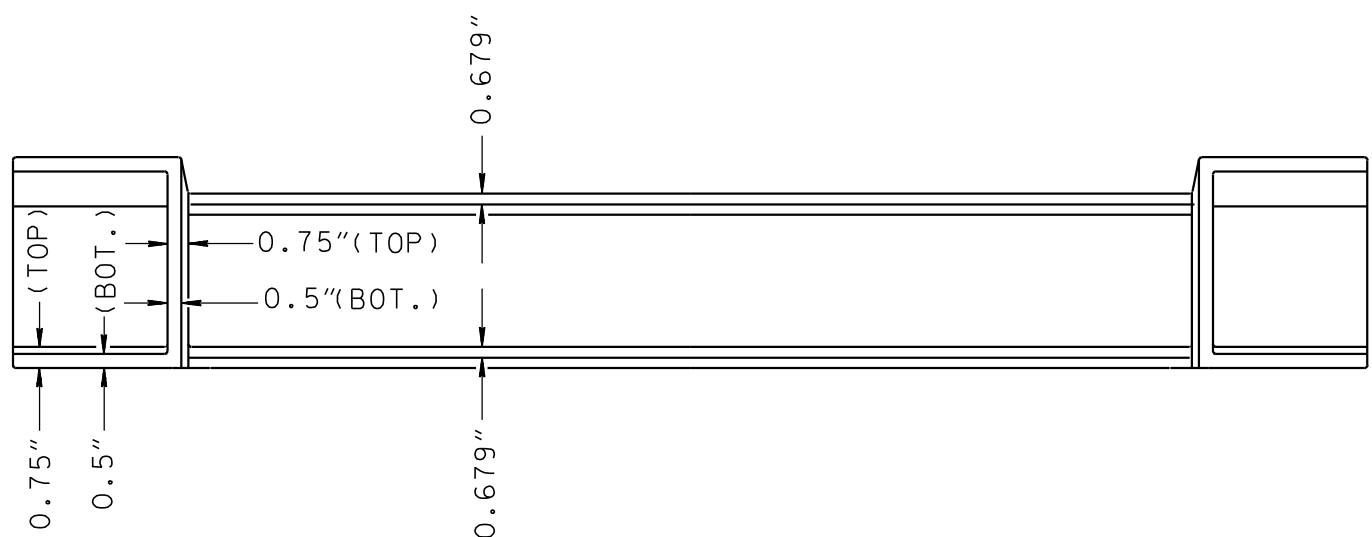

BOTTOM

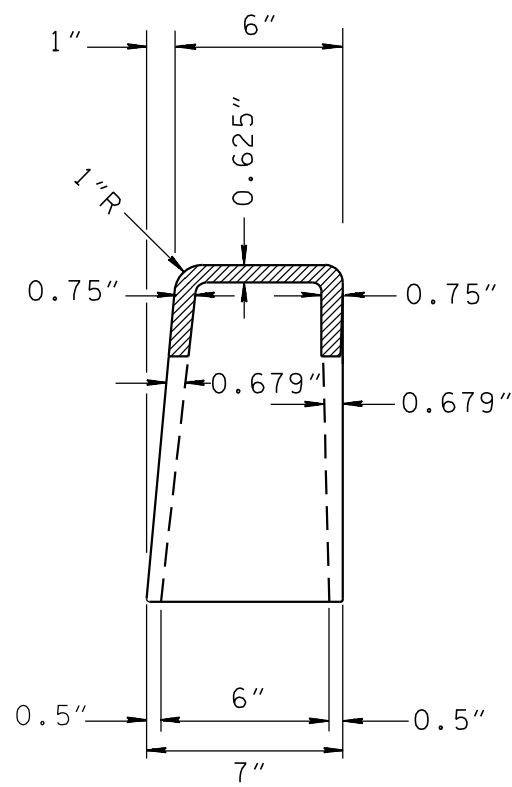

SECTION E-E

- REV. 10-26-93: REDREW SHEET, REORGANIZED SHEET AND UPDATED TO 1993 POLICY.
- REV. 9-05-94: MODIFIED CURB INLET CASTING DETAIL.
- REV. 1-19-95: CHANGED WEIGHT OF CURB INLET CASING FROM 150 TO 155 POUNDS.
- REV. 5-27-95: CHANGED GENERAL NOTE (A).
- REV. 5-27-97: CHANGED GENERAL NOTE (A). DELETED OLD GENERAL NOTE (C). CHANGED DESCRIPTION IN RIGHT LOWER CORNER BLOCK.
- REV. 1-19-98: CHANGED GENERAL NOTE (A).
- REV. 12-18-99: CHANGED LOWER RIGHT HAND CORNER BLOCK DESCRIPTION.
- REV. 5-27-01: CHANGED GENERAL NOTE (D).

GENERAL NOTES

- (A) WHEN A SIX (6) INCH NONMOUNTABLE CURB IS REQUIRED USE THIS DRAWING ON ALL VARIATIONS OF NUMBER 10, 12, 14, 16, AND 17 CATCH BASINS CONTAINED IN THIS SECTION OF THE STANDARD DRAWINGS.
- (B) FOR CLEARNESS, ALL CORNERS ARE SHOWN ON THIS DRAWING BY STRAIGHT LINES WITH THE EXCEPTION OF THE 1" RADIUS AT THE TOP OF FACE OF CURB. ALL INSIDE CORNERS SHOULD BE MADE WITH 1/2" x 1/2" FILLETS OR 3/4" RADIUS FILLETS FOR EASE IN MOULDING.
- (C) IF PAID FOR SEPARATELY CAST IRON USED IN CASTINGS IS TO BE PAID FOR UNDER ITEM NO. 611-03.04 GRAY IRON CASTINGS (CATCH BASIN) PER POUND.
- (D) IF CATCH BASIN IS PAID FOR UNDER EACH, THEN COST OF CAST IRON USED IN CASTINGS IS TO BE PAID FOR UNDER THE SPECIFIC ITEM BID FOR THAT CATCH BASIN. SEE STANDARD DRAWINGS FOR TYPE 10, 12, 14, 16, AND 17 CATCH BASINS FOR APPLICABLE PAY ITEMS FOR EACH TYPE OF CATCH BASIN.

WEIGHTS

(SINGLE GRATE CATCH BASIN)	
FRAME -----	265 LBS.
GRATE -----	250 LBS.
CURB INLET ----	155 LBS.
* TOTAL -----	670 LBS.
* NOTE: WEIGHT OF TWO GRATES = 1,340 LBS.	
* NOTE: FOR NO. 10 CATCH BASIN, DEDUCT 155 LBS. PER " GRATE ", SINCE NO CURB INLET IS REQUIRED.	

FRACTION TABLE

1/8"	-	0.125"
1/4"	-	0.250"
3/8"	-	0.375"
1/2"	-	0.500"
5/8"	-	0.625"
1 1/16"	-	0.688"
3/4"	-	0.750"

MINOR REVISION -- FHWA APPROVAL NOT REQUIRED.

STATE OF TENNESSEE
DEPARTMENT OF TRANSPORTATION

TYPE 'B'
CAST IRON FRAME, GRATE
& NONMOUNTABLE INLET
DETAILS FOR NOS.
10, 12, 14, 16 & 17
TYPE CATCH BASINS

1-20-84

D-CBB-12A